

DEEPOWER V8

E-BIKE USER MANUAL



ATTENTION

Please read this manual carefully before using the DEEPOWER electric bicycle. If you do not understand this manual, or if you do not solve the issues covered in this manual, please contact The seller

IMPORTANCE

When using the electric bicycle, basic safety precautions should always be followed including the following:

1. Read all instructions.
2. To protect against fire, electric shock and injury to persons, do not immerse cord, plugs, or e-bike in water or other liquid.
3. Close supervision is necessary when the e-bike is used by or near children.
4. Unplug from outlet when not in charging and before cleaning.
5. Do not operate the e-bike with a damaged cord or plug or after the e-bike malfunctions, or has been damaged in any manner. Take the e-bike to the nearest authorized service bike shop for examination, repair or adjustment.
6. The use of accessory attachments not recommended by the e-bike manufacturer may result in fire, electric shock or injury to persons.
7. Do waterproof when using on a rainy or snowy day.
8. Do not let cord hang over the edge of table or counter, or touch hot surfaces.
9. Do not place on or near a hot gas or electric burner, or a heated oven.
10. Always attach the plug to the battery first, then plug the cord into the wall outlet.
11. Do not use the bike for other than intended use.
12. SAVE THESE INSTRUCTIONS

PLEASE NOTE:

1. This manual is not intended as a detailed user, service, repair or maintenance manual.
Please seek assistance from a qualified technician for service, repairs or maintenance.
2. Instructions are for reference only, actual bike parts parameters may vary

Read This First: Safety and Compliance with the Law

Congratulations on your purchasing of your new e-bike. Your new e-bike is an excellent piece of personal transportation equipment that will give you good service for many years. Before you start using your e-bike, we want you to be aware of a few important points. Please read this section carefully.

• **Observe Laws Regarding the Use of Battery-Operated Bicycles**

Your e-bike is designed and manufactured to meet safety requirements as a battery-operated bicycle. However, state and local laws governing the use of battery-operated bicycles on public roadways, parks, and other open areas may differ. Please check with your local authority before using your e-bike in public areas.

• **Observe Laws Regarding the Use of Bicycles**

Note that all laws regarding the use of bicycles in public areas, such as those mandating the use of helmets and the use of infant seats, will automatically apply for e-bikes. Check with your local authority on what restrictions might apply.

•The Lithium-ion Battery of Your e-Bike

Your e-bike is equipped with the latest battery technology. The lithium-ion battery is much lighter than lead-or nickel-based batteries that are being used in some older models.

•Your First Ride

Please be VERY CAREFUL when you are ready to get on your e-bike for the first time because that the e-bike moves significantly faster than a regular bicycle at active power- assisted mode. Take your e-bike to an area with a lot of open space before you start.

Do not start pedaling hard as soon as you get on the e-bike (as you normally would be with a regular bicycle), as the e-bike will accelerate under pedal-assist mode and you may be unprepared for the sudden increase in speed.

However, after a few times, you will enjoy using the pedal-assisted function.

01 ABOUT THIS MANUAL

This manual was written to help you get the most performance, comfort, enjoyment, and safety when riding your new DEEPOWER E-bike. The manual describes specific care and maintenance procedures that help protect your warranty and ensure years of trouble-free use. Please pay particular attention to the section on battery charging and maintenance. It is important for you to understand your new DEEPOWER

E-bike, its features, and its operation, so you get maximum enjoyment with maximum safety. By reading this manual before you go out on your first ride, you'll know how to get the most from your new DEEPOWER E-bike.

It is also important that your first ride on a new DEEPOWER E-Bike is taken in a controlled environment, away from cars, obstacles, and other cyclists.

02 OPERATIONAL INSTRUCTIONS



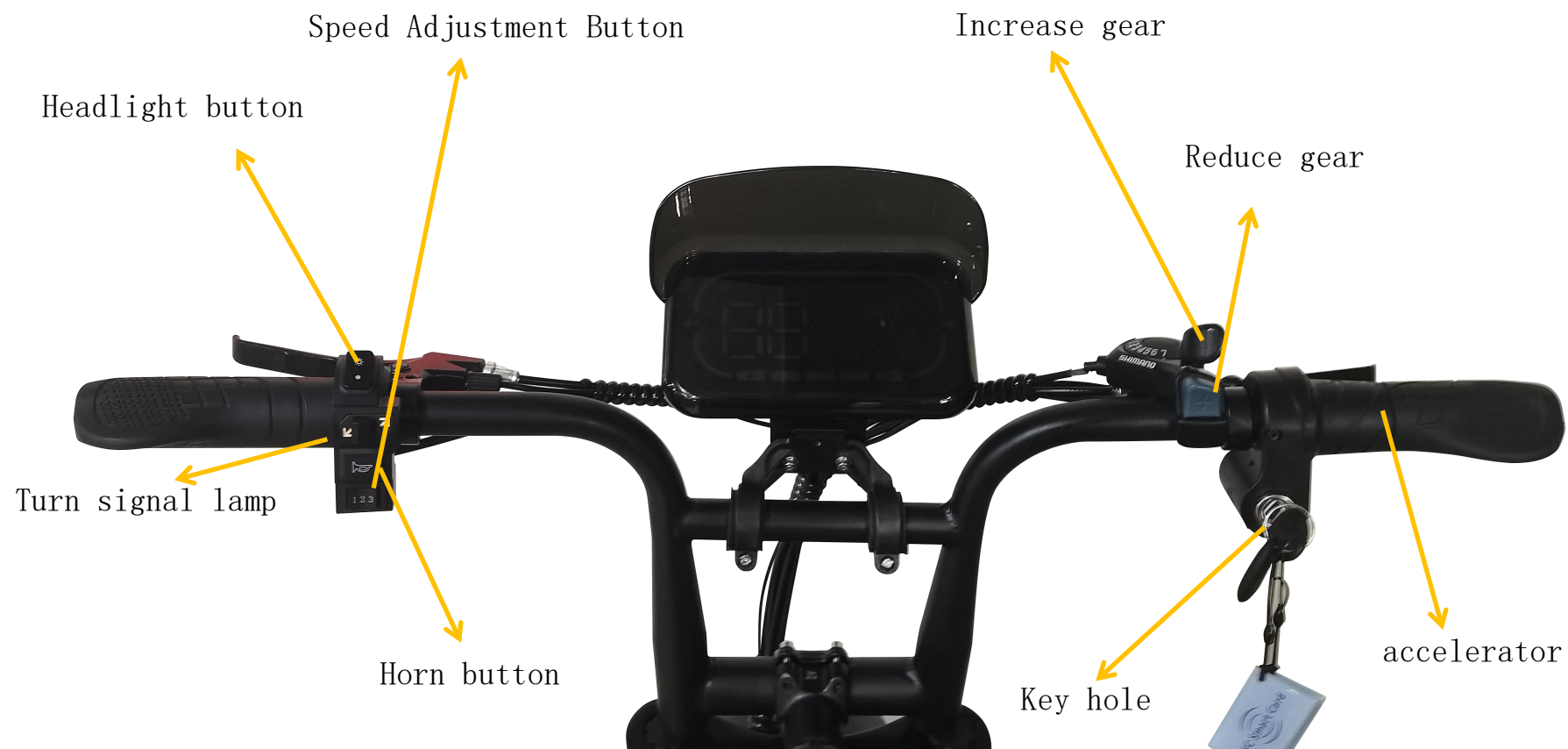

03 NCOMPONENT INSTALLATION NOTES

PART 1:HANDLEBAR ASSEMBLY



01
Loosen the riser sides A,B screws
*Before installation, pay attention to the front and rear brakes always on the same side



02
Fix the front shock absorber and rotate the riser 180°



03
Tighten the side A,B screws

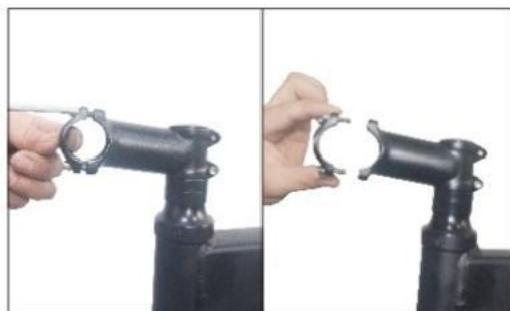

04
Remove front 4 bolts from stem cover them remove stem cover



05
Mount handlebar onto stem, then replace stem cover and tighten all 4 bolts



06
Adjust handlebar according to your needs, then ensure all bolts are tightened firmly

PART 2: HEADLIGHT & FRONT WHEEL ASSEMBLY



01
Assembled wheel



02
There is an iron bar at the bottom of the wheel



03
Remove the iron bar with a screwdriver



04
Find the connecting rod of the wheel (it is black)



05
Remove one end with a wrench and insert it into the middle of the wheel



06
Install relatively large ring shaped parts

PART 3: PEDAL AND SADDLE MOUNTING&DIRECTION ADJUSTMENT



01
Put the wheel on the end of the front fork (you may need help from another person)



02
Install the part in the shape of the water drop, the upper part of the bend into the hole (very important)



03
Install small rings



04
Mounting nut



05
Tighten the nut with a wrench



06
The white iron bar you just took down can be discarded

PART 4:FOLDING THE FRAME&REMOVING THE BATTERY



01
Remove battery



02
The battery is marked with the direction of locking and unlocking



03
After unlocking the battery, push the battery upward to remove it (you need a lot of force because the battery is heavy)



04
On the other side of the battery key is the charging port, you can put the battery on the bike to charge it, or you can take it off



Press and hold the button on the battery to see how much power is left



The red button is meaningless and nothing will happen if you use it

04 RECHARGING THE BATTERY

RECHARGING THE BATTERY



ATTENTION

Connect the battery first, then connect the power supply and make sure the red LED of the charger is lit. The charger will charge the completed battery within 3 to 7 hours.

A red light indicates that the battery is charging. A green light indicates that the battery is fully charged.

05 GEARS



Reduced gear, more labor-saving, strong output power, suitable for uphill and acceleration.



Add gears, It's faster but it's hard.

06 LED DISPLAY

RIDING MODES

Power Assist System(PAS)

PAS 0:Full electric pow,no power assistance

PAS 1:Low speed level

PAS 2:Medium speed level

PAS3:High speed level

PAS 4:Very high speed level

PAS5:Maximum speed level

To ride in full electric mode(no pedaling),set your

LED display to PAS 0.In this mode,your speed can

be changed by twisting the throttle.

The speeds listed here are only for reference,Actual speeds will be affected by rider weight temperature, road situations,incline,battery status,etc.



07 KEYS

*Your DEEPOWER electric bike comes with one or two keys

*Ignition key

*The key to the battery holder on the bicycle frame

WARNING

Keep out of reach of children,Always keep your

keys in a safe place to avoid losing them.

08

INSPECTION & MAINTENANCE

Hand brake cut-off power

When your bike is equipped with brake cut-off power set, the bike will automatically cut off power when the brake is used.

Low voltage protection

When the battery output voltage reaches its limit, the electronic control system will cut off the power to automatically protect the battery. When the battery reaches its minimum voltage, you can switch to pedal riding. The battery should be recharged before riding again.

Power off

When your E-Bike is not in use, please turn off the power.

Charge indicator

Red indicates charging, green indicates that the battery is full.

Note: The battery switch must be turned off using the switch on the bottom when the battery is charging. The battery must be fully charged before the first use. We recommend you charge the battery for a full 6 hours after your first 3 uses. If the bike is not used for a long time, you should fully charge and remove the battery.

While not in use, keep the battery turned off and recharge every 2 months.

Make sure to keep the battery and charger away from children during charging.

Do not attempt to disassemble or modify the battery or charger.

Do not use the battery or charger for any use other than its intended purpose.

Battery charging

Plug in the connector between the charger and the battery, then plug the charger into an electrical outlet. The LED indicator on the charger will show red, which means charging. When the indicator light turns green, the battery is fully charged. When you are finished charging, first unplug the charger from the power supply, and then unplug the connector between the battery and the charger.

During the charging process, the charger and battery should be placed in a stable and cool place. The battery operating temperature range should be between 32 and 110 degrees Fahrenheit.

Do not put any cover on the battery or charger. Make sure that no liquid comes into contact with the charger.

BASIC MAINTENANCE

Mileage

Performance of electric bicycles is affected by road conditions, rider/load weight, and weather conditions. We recommend that you manually pedal as often as possible to

Inclines

improve your travel distance and

When riding uphill on an incline of 15 degrees or more, we recommend using the pedal to assist your climb.

Cleaning

When cleaning your electric bicycle, wipe with a dry or damp cloth, do not spray directly with a hose. Do not put oil on the front brake.

The seat tube should be cleaned and lubricated if necessary.

1. To ensure that your E-Bike is in the best condition, maintain and clean regularly.
2. Regularly check that the tires are inflated correctly.
3. Make sure that quick release, nuts and bolts are tightened.
4. After a period of riding, check that the spoke tension is normal. Adjust as needed.
5. The frame and other parts are made of aluminum alloy. Avoid friction or collision and clean it regularly.
6. Do not take apart the motor, battery, or controller yourself. If necessary, take your E-Bike to a professional bicycle technician for repairs.
7. Do not use high-pressure water to clean your E-Bike. Keep water away from the controller, battery and motor.
8. Lubricate the chain, flywheel, head parts, kickstand, etc. when necessary.

09

WARRANTY CERTIFICATE

Important

DEEPOWER warranties against manufacturer defects for all of our regular electric bikes and parts ,except accessories.

The warranty period begins on the delivery date within twelve(12)months.

Please note this warranty only covers the initial purchaser and DOES NOT cover accessories.

Validity

The warranty is valid only when:

- a)The Product is purchased from DEEPOWER authorized dealers or outlets.
- b)The Product is NOT transferable to any third party either in ownership or during the period of contract.
- c)The model and serial label should not be defaced or removed from the Product.

Exclusion

- a)Damage or loss caused by modification,alteration,or repair by any unauthorized party.
- b)Damage or loss caused by mishandling by the customer or person(s)with access to the product on the customer's premises.
- c)Normal wear and tear.
- d)Damage or loss caused by Acts of God or any other causes beyond DEEPOWER control.

e)Damage or loss as a result of external bodies.

f)Damage or loss caused by another device that is connected to the Product.

g)Damage resulting from accidents,misuse,abuse,tampering,or failure of the customer to follow normal operating procedure outlined in the user manual.

h)General maintenance and servicing.

DEEPOWER E-Bike Warranty

In the rare case that your E-Bike arrives and does not work, In order to honor the warranty the following must be followed:

- If your E-Bike is received with a defect,DEEPOWER will take care of the shipping fees(at DEEPOWER instruction)and immediately ship replacement equipment or repair the equipment.
- If your E-Bike is in need of repairs,the owner must contact DEEPOWER will receive a Return Authorization (RA)Number and all of the necessary information.DEEPOWER will not accept returns without an RA.
- All returns must be properly packaged to prevent damage during shipment.An explanation of the problem or damage and a proof of purchase must be submitted with the return which will be shipped by the owner.
- The RA number must be clearly visible.
- The owner will be responsible for insurance of the merchandise (at owner's cost)because DEEPOWER will not be responsible for damages or losses during shipment.

The warranty is void if:

The damages are a result of an accident, abuse, alteration, non-authorized usage, or use of electricity other than that indicated in this manual.

The warranty is void if:

The owner or user neglected to do routine maintenance required and the damages or problems are directly related to such neglect. It is the user's responsibility to keep the E-Bike in proper condition.

Certain parts of the equipment are not covered by the warranty due to the fact that they require replacement after multiple uses. For example: buttons, pedals, seats, tires, etc. These parts will eventually require replacement at the owner's cost.

The manufacturer will not be held responsible for damages or monetary losses related to the purchase or use of their products. DEEPOWER denies responsibility for all physical and moral damages linked to the purchase and use of their products. In all cases, the damages can not exceed the purchase price paid by the initial owner.

The final decision to honor the warranty is taken by DEEPOWER personally after a technical inspection when the owner returns defective products.

The warranty excludes:

1. Replacement and shipping costs of products worn out by normal use
2. Replacement and shipping costs of products due to problems related to neglect, abuse, or lack of maintenance.

Shenzhen Miracle Niu intelligent Technology Co.,Ltd
Address: Room 6E006-007, Phase II, No.1 Huanan Avenue ,
Longgang Dist, Shenzhen, Guangdong, China
Email: Deepowery@outlook.com

*Please note that this is a general manual. So, the frame style and accessories of the electric bicycle (e-Bike) that you have may differ from the picture shown in this manual.

The manufacturer reserves the right to change the features of the product without prior notice.

